



Dutchman Real Estate | *Real Estate Success*

FOR SALE
.57 acres
Commercial Potential

168 S MAIN ST., FORISTELL, MO 63348



INFORMATION

Lot: 0.57 +/- AC

Zoning: Residential with commercial potential.

Utilities: Near Site

School District: Wentzville

*Location: Minutes from I-70
across Hwy from High School*

FOR SALE: \$29,900.00

For More Information Contact:

Jeremy Malensky, CCIM

Cell: 314-267-2665

Office: 636-949-0777

Jeremy@dutchmanrealty.com



Dutchman Real Estate | *Real Estate Success*

FOR SALE
.57 acres
Commercial Potential

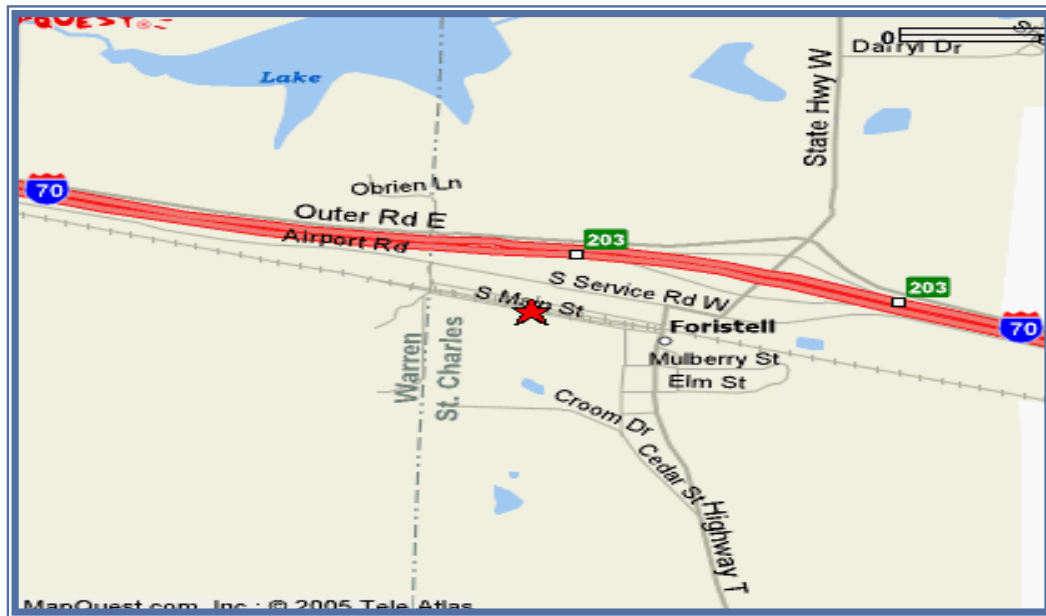
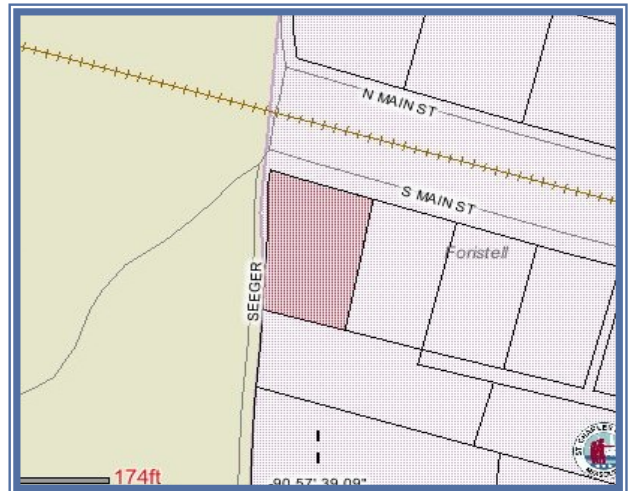

DIRECTIONS: Hwy 70 West to Highway W (exit 203). Go toward Highway T/Foristell. Turn left on Highway W to right onto S. Service Road. Turn left onto Highway T and right onto Main Street.

For More Information Contact:
Jeremy Malensky, CCIM

Cell: 314-267-2665

Office: 636-949-0777

Jeremy@dutchmanrealty.com

2507 Hwy K, O'Fallon, MO 63368 | DutchmanRealty.com | DutchmanHomes.com

THIS INFORMATION IS THOUGHT TO BE ACCURATE. HOWEVER IT IS SUBJECT TO VERIFICATION AND NO LIABILITY FOR ERRORS OR OMISSIONS IS ASSUMED. THERE ARE NO WARRANTIES, EXPRESSED OR IMPLIED, AS TO THE INFORMATION HEREIN CONTAINED, AND IT IS RECOMMENDED THAT ALL BUYERS SHOULD MAKE A PERSONAL INSPECTION OF THE PROPERTY. THE LISTING MAY BE WITHDRAWN WITH OR WITHOUT NOTICE AND THE STATED PRICE IS SUBJECT TO CHANGE WITHOUT NOTICE OR APPROVAL. THE SELLER FURTHER RESERVES THE RIGHT TO REJECT ANY AND ALL OTHERS. ALL INQUIRIES, INSPECTIONS, APPOINTMENTS AND OFFERS MUST BE HANDLED BY DUTCHMAN REALTY, INC.