

A COLORED TAKEDOWN EXHIBIT FOR COTTLEVILLE TRAILS

A COLORED TAKEDOWN EXHIBIT FOR
COTTLEVILLE TRAILS
HIGHWAY N
CITY OF COTTLEVILLE, ST. CHARLES COUNTY, MO, 63304



**ENGINEERING
PLANNING
SURVEYING**
221 Point West Blvd.
St. Charles, MO 63301
636-928-5552
FAX 928-1718

Bay Engineering Company, Inc.
Missouri State Certificate of Authority
Engineering #000655
Missouri State Certificate of Authority
Surveying #002144

REVISIONS

NO.	DATE	DESCRIPTION

DISCLAIMER OF RESPONSIBILITY
I hereby disclaim any responsibility for all other drawings, specifications, estimates, reports or other documents or instruments relating to or intended to be used for any part or parts of the architectural or engineering project or survey other than those authorized by my seal.

07/23/2020
DATE
18-17470
PROJECT NUMBER
17470colored
FILE NAME
CLM
DRAWN
DJR CLH
DESIGNED CHECKED

COLORED
TAKEDOWN
EXHIBIT WITH
PHASING

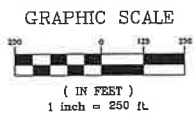
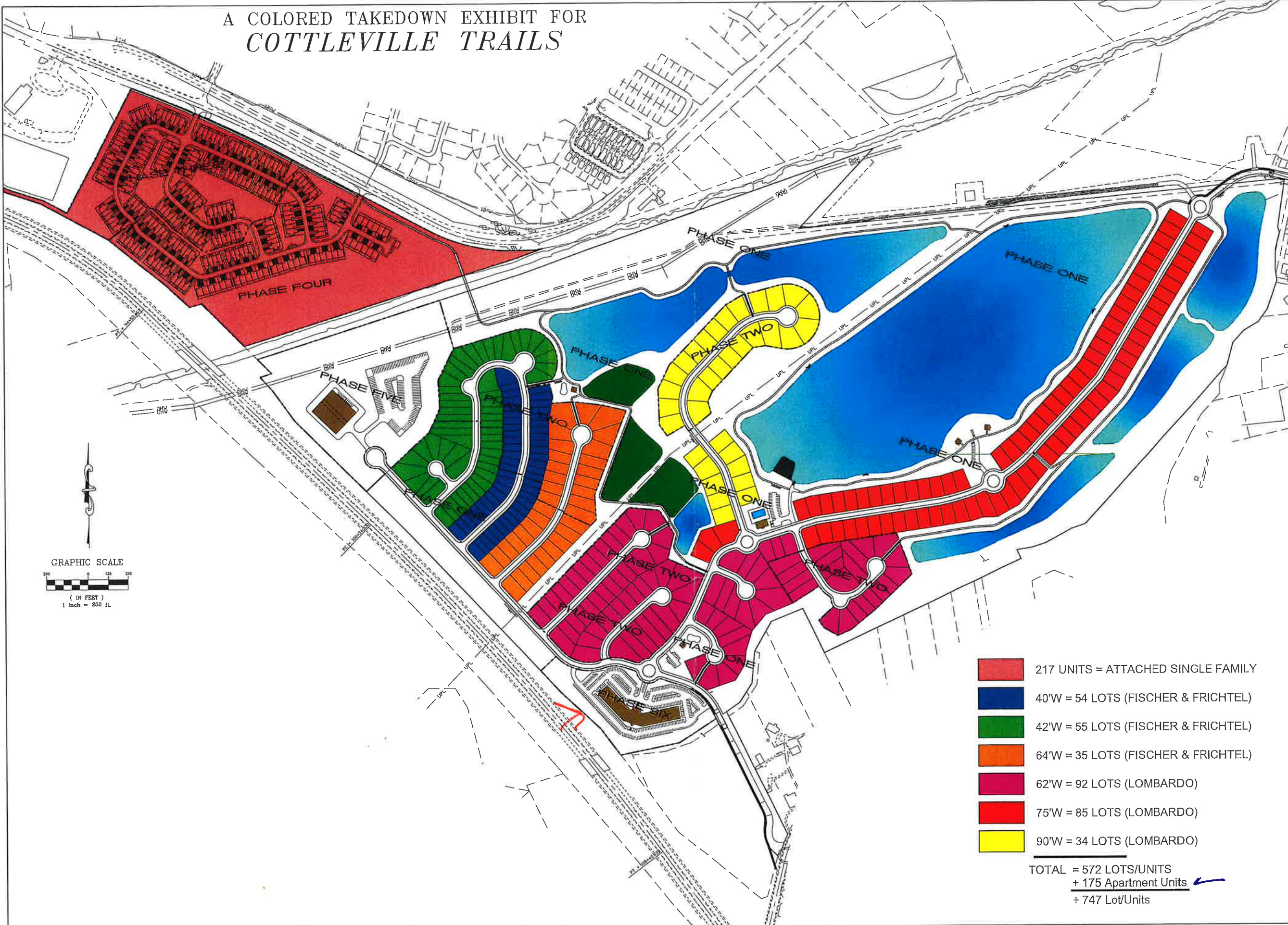

- 217 UNITS = ATTACHED SINGLE FAMILY
 - 40'W = 54 LOTS (FISCHER & FRICHTEL)
 - 42'W = 55 LOTS (FISCHER & FRICHTEL)
 - 64'W = 35 LOTS (FISCHER & FRICHTEL)
 - 62'W = 92 LOTS (LOMBARDO)
 - 75'W = 85 LOTS (LOMBARDO)
 - 90'W = 34 LOTS (LOMBARDO)
- TOTAL = 572 LOTS/UNITS
+ 175 Apartment Units
+ 747 Lot/Units